

LOT PLAN

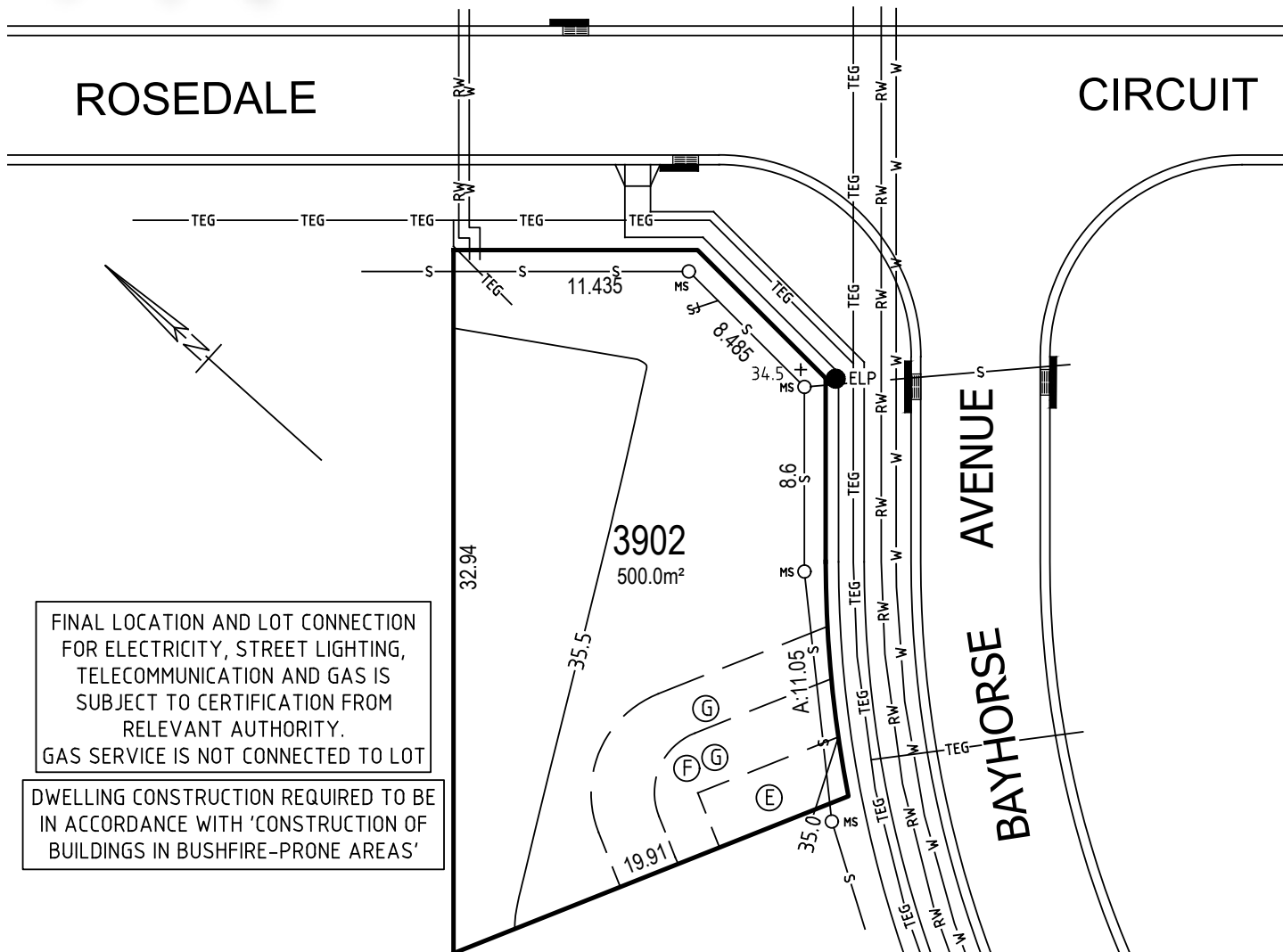

LOT 3902



FINAL LOCATION AND LOT CONNECTION FOR ELECTRICITY, STREET LIGHTING, TELECOMMUNICATION AND GAS IS SUBJECT TO CERTIFICATION FROM RELEVANT AUTHORITY. GAS SERVICE IS NOT CONNECTED TO LOT

DWELLING CONSTRUCTION REQUIRED TO BE IN ACCORDANCE WITH 'CONSTRUCTION OF BUILDINGS IN BUSHFIRE-PRONE AREAS'

- LEGEND**
- TEG— ELECTRICITY, TELECOMMUNICATIONS AND GAS
 - TE— ELECTRICITY, TELECOMMUNICATIONS
 - S— SEWER
 - W— WATER
 - RW— RECYCLED WATER
 - SW— STORMWATER
 - 47— CONTOUR
 - ELP LIGHT POLE
 - EP ELECTRICITY PILLAR
 - SAC ACCESS CHAMBER
 - MS MAINTENANCE SHAFT
 - S— SEWER JUNCTION
 - STORMWATER LINTEL & GRATE

- ⓔ EASEMENT FOR PADMOUNT SUBSTATION 2.75 WIDE
- ⓕ RESTRICTION ON THE USE OF LAND
- ⓖ RESTRICTION ON THE USE OF LAND

